

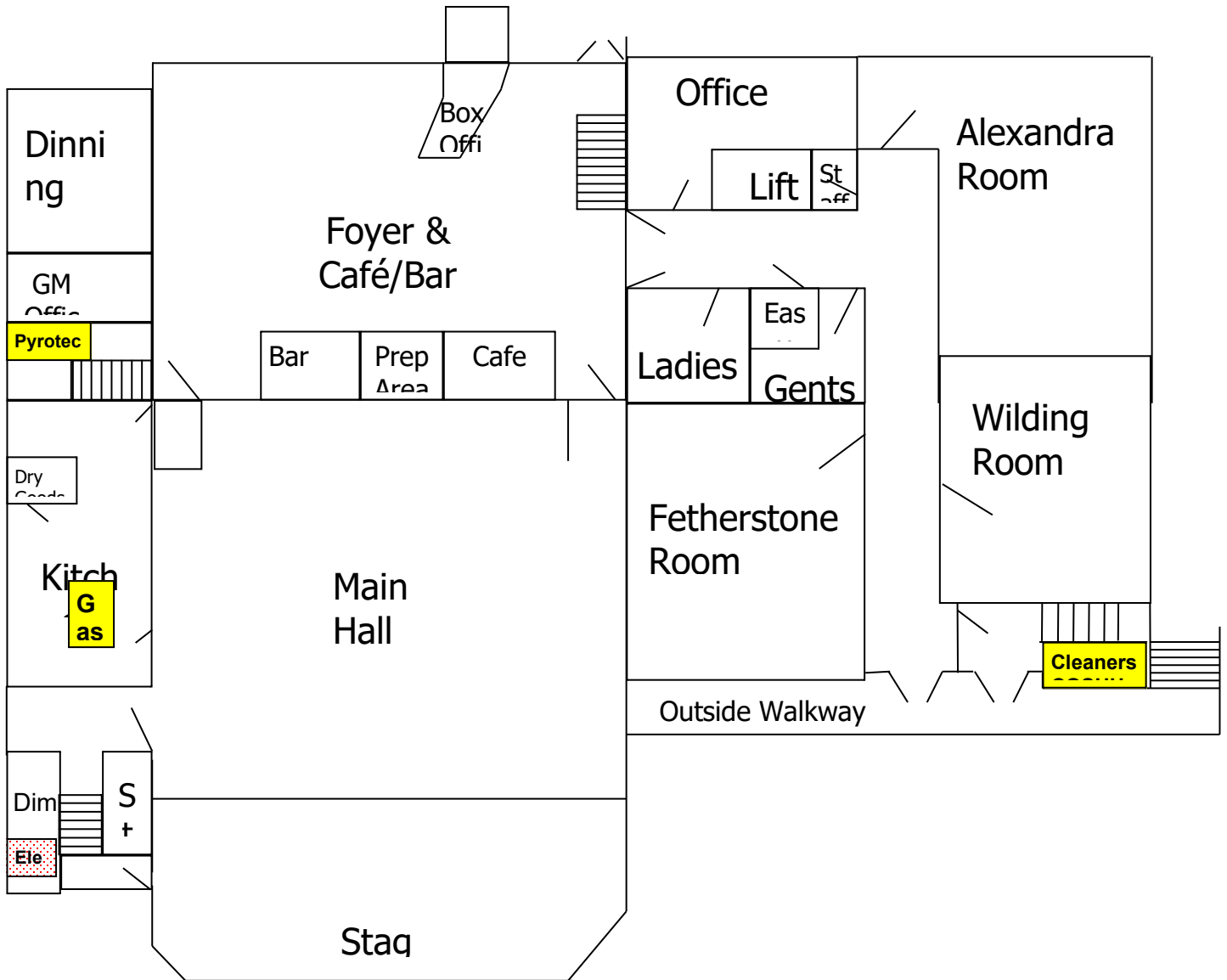

Technical Specification

January 2025

	Contacts
	Logistics
Page 2	Stage Measurements
	Scenery
	Special Effects & Health and Safety
	Flying Systems
Page 3	House Tabs
	Dressing Rooms
	Communications
Page 4	Lighting Equipment
Page 5	Sound Equipment
	Digital Cinema and Alternative Content
Page 6	Power
	Rostra
	Masking
	Stage Management
Page 7	Additional Equipment
	Staffing



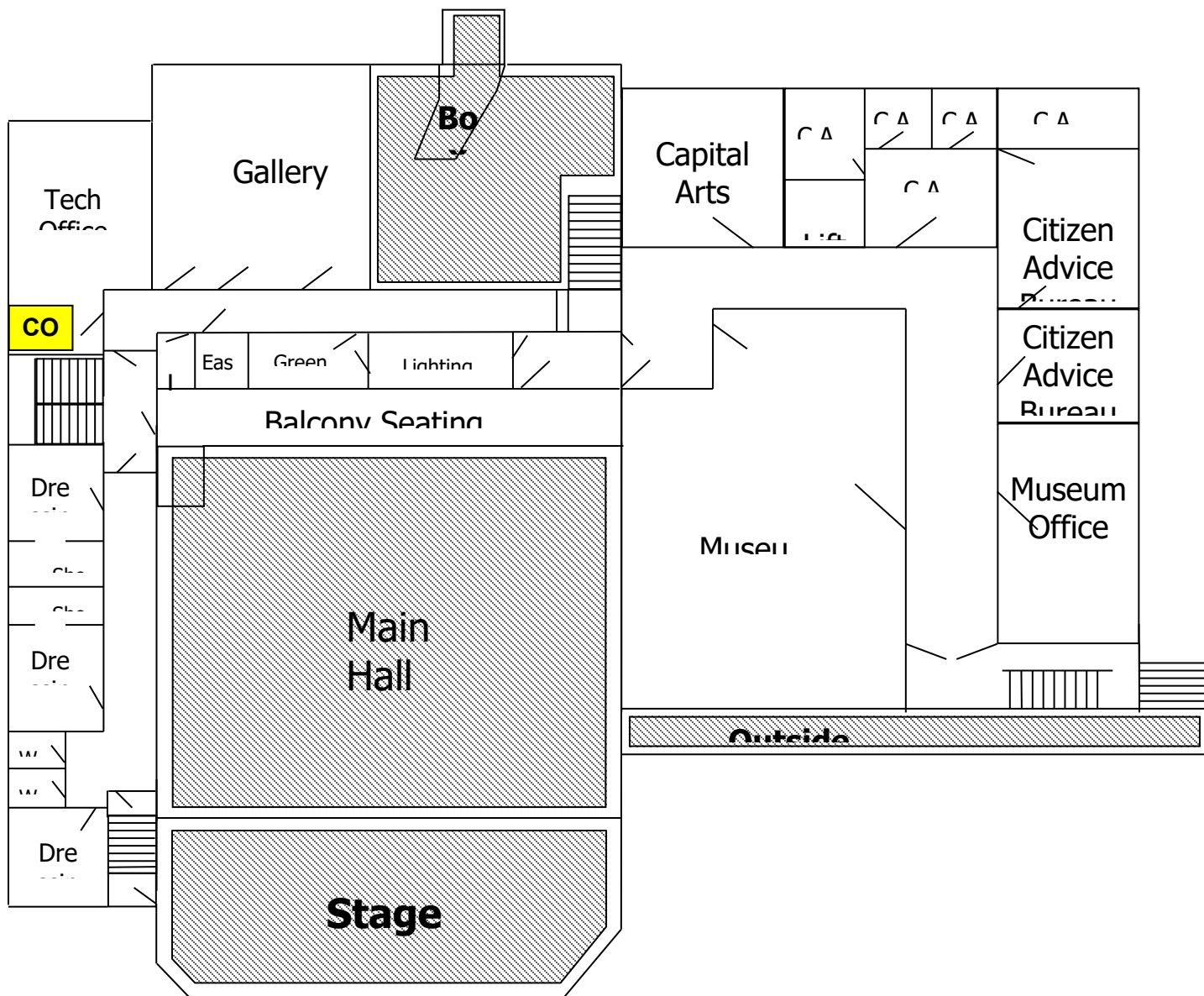

Contacts	
Technical Manager	Nigel Palmer Nigel.palmer@inspireall.com 07517 005006
Senior Projectionist & Technician	Gary Fisher
Technicians	Ellie Batchelor Kian Richards
Logistics	
Entrance to auditorium from street level, Entrance to stage from Stairs SL or ramp onto stage during show Get-in/out (W3W Limbs.Intro.Post)	
Stage Door Dimensions:	Height: 2.55m (8'5") Width: 1.18m (3'10")
Minimal parking is available in the loading area outside of the stage door. Additional pay and display parking is available adjacent to the theatre and in the underground car park beneath the theatre.	
Stage Measurements	
Upstage Width:	14.70m (48'2")
Downstage Width Min: <i>Proscenium arch in</i>	8.83m (28'11")
Downstage Width Max: <i>Proscenium arch out</i>	13.13m (43'1")
Depth:	6.38m (20'95")
Stage Thrust: <i>When installed</i>	1.22m (4'0")
Proscenium Arch Height:	4.23m (14'17")
Max height of motorized bars	6mtrs
Max height of hemp bars	5.5mtrs
Max height of curtain tracks	5.25mtrs
Height of stage fixed bars	8.75mtrs
Max height of motorized advance 1	5.75mtrs
Max height of fixed advance 2	5.9mtrs
Stage to roof	8mtrs

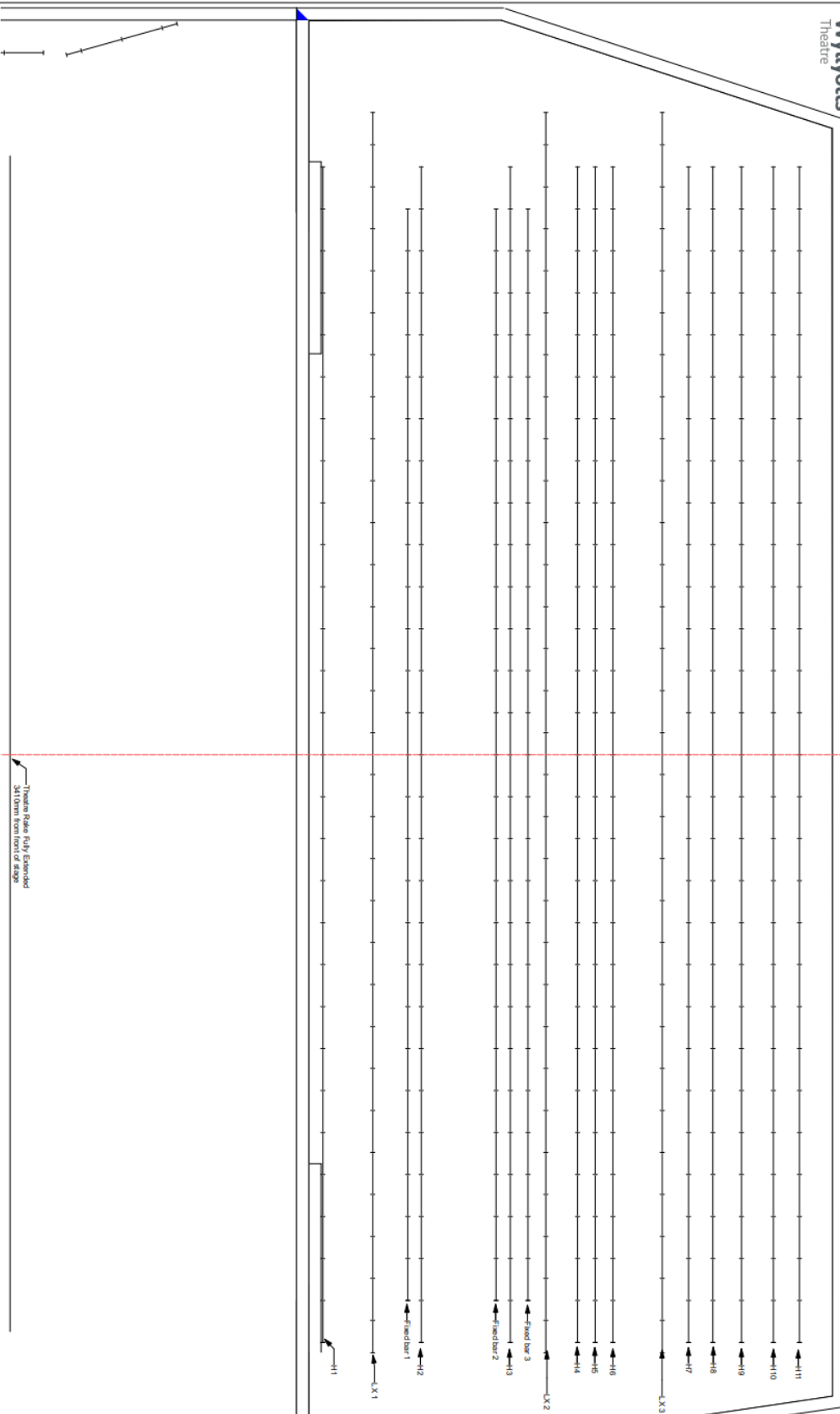

Scenery
<p>All scenery should conform to theatre licensing regulations. <i>Please speak to technical staff if you have any queries.</i></p>
Special Effects & Health and Safety
<p>For the use of pyrotechnics, smoke, dry ice, firearms, strobe or any other special effects, Wyllyotts requires a minimum of <u>14 days</u> notice provided to us in writing for your request to be granted.</p> <p>Wyllyotts Theatre requires you to submit all paperwork (including risk assessment and safe system of work) with notice as stated above. Should you require assistance with this please contact the Technical Manager.</p> <p><i>Wyllyotts Theatre reserves the right to refuse the use of any special effects, rigging, electrical equipment and access equipment should you be unable to provide adequate risk assessment, safe system of work and certificates.)</i></p>

Flying Systems	
<p>11 Hemp Lines operated from Stage Right <i>SWL of 90kg</i> <i>Hemp 10 SWL of 125kg</i></p> <p>4 Pilewind motors for lighting bars <i>SWL of 250kg</i> <i>3 Overhead, 1 Front of House</i> <i>For more information see flying plot.</i></p> <p>1 Fixed lighting bar front of house (advanced 2) <i>SWL of 100kg</i></p> <p>2 Fixed scenery bars over stage <i>SWL of 100kg</i></p> <p>10 Fixed vertical bars evenly distributed along auditorium walls <i>Split 5 x SL & 5 x SR</i></p>	
House Tabs	
<p>Wylllyotts' red crushed velvet tabs are motorised and have a fixed running speed. They can be operated from the prompt desk, sound control area or the projection room.</p>	
Dressing Rooms	
Dressing Room 1	<p>Up to 12 people <i>3 hand basins and 7 lit mirrors</i></p>
Dressing Room 2	<p>Up to 7 people <i>1 hand basin, shower and 4 lit mirrors</i></p>
Dressing Room 3	<p>Up to 7 people <i>1 hand basin, shower and 4 lit mirrors</i></p>
Gallery (may be re-charged)	Up to 25 people
<p><i>Additional dressing room spaces are available by prior arrangement with the Theatre Management</i></p> <p>All dressing rooms have 6' costume rails and 2 safes <i>Keys are obtainable from the Duty Technician. Loss of keys will be charged to the client.</i></p>	
Communications	
<p>Intercom System installed with the following positions:</p> <p>Prompt Desk Lighting position Sound position Followspot 1&2</p> <p><i>Additional comms positions can be added upon request</i></p>	
<p>Assorted belt packs and headsets</p>	

Lighting Equipment			
Power	Three Phase 200Amp Supply		
Dimming	Strand Wall Rack Digital Dimmers providing 96 x 10 _A Circuits LSC E-Pro Digital Dimmers in portable rack providing 24 x 10 _A Circuits via 4 Socapex Out Wylllyotts can provide 4 x 20m Socapex cable and 4 x fan out		
Control	ETC Ion Xe		
Dimmer Distro	1-6	FOH Perch SL	
	7-14	Advanced 2 (paired outer to inner)	
	15-20	FOH Perch SR	
	21-38	Advanced 1 (37 & 38 paired at outer)	
	39-40	Front of stage dip circuits	
	41-56	LX1 (+ 2 x 16 _A Hard Power)	
	57-72	LX2 (+ 2 x 16 _A Hard Power)	
	73-88	LX3 (+ 2 x 16 _A Hard Power)	
	89-96	Stage dip circuits paired SL & SR	
Luminaires	Profiles	4	Strand SL 15/32° Profile Spots 575w
		4	Strand SL 23/50° Profile Spots 575w
	Par Can	10	Par 64 1K (Assorted lamps available)
	Floods	5	Chauvet Cyc
		2	6 cell blinders
	2 x 18" mirror Ball		
	RGB Starcloth		
	Intelligent	11	Chauvet Rogue R2 LED Moving Wash
		14	Chauvet Par56-FC
		2	Chauvet Reve – E3 Spot 50°
		2	Fussion Equinox Spot
		2	LEDJ Event Spot RGBW
	Followspot	2	Robert Juliatt Manon (1200w MS) on RJ leg stands with sights
Additional lighting equipment can be hired by arrangement with the Technical Manager.			

Sound Equipment			
Distro	Stage Boxes SL/SR:		8 XLR Send 4 XLR Return
	Full patching facility as control position		
	Dante 32/16 Digital Rio Boxes		
Mixer	Yamaha QL5		
Output	FOH Mid/Hi	L&R	2 x JBL SRX 722
		C	1 x JBL SRX 712
	Sub	C	1 x JBL SRX 728s (Dual 18")
	Delay	Mid	4 x JBL Control 28 (20' from Pros.)
		Rear	4 x JBL Control 28 (40' from Pros.)
	Monitoring	4 x Ohm TRS-112 (Passive)	
Amplifiers	FOH	4 x QSC PLX2502 1 x QSC CX4	
	Foldback	2 x QSC RMX 750	
Processing	Built into Yamaha QL5		
Microphones	9 x Shure SM58		
	5 x Shure SM57		
	2 x Shure Smbeta87		
	3 x Sure Smbeta98 (drummics)		
	1 x AKG C 568 EB		
	1 x AKG D112 (kick drum mic)		
	2 x AKG SE300 with CK91 head		
	3 x Pulse		
	1 x Sennheiser MD 421		
Radio Mics	12 Sennheiser Ew-D SK Bodypack (+ spare)		
	2 x Sennheiser Ew G4 Handheld		
	Various Lapel and Headset mics		
DI	3 x Single DI		
	2 x Stereo DI		
Playback	1x Mac Mini - Running Qlab		

Digital Cinema and Alternative Content		
Formats	Dolby Show Server, DCP	
	HDMI – From Anywhere within the theatre	
	Live Satellite Streaming	
	Blu-ray LG player	
Screen	Perlux 180, electrically flown roller screen. See flying plot for location. Takes 3 mins to roll in.	
Projection	Barco CP2K-15c	
	Christie LX700 (7000ansi Lumen)	
Sound	Dolby CP650 Processor <i>With:</i> 7.1 Surround from Dolby Show Server 5.1 Surround from Tascam DVD Player Stereo from all other sound sources	
Please contact the Technical Department as early in advance as possible if you plan on using our cinema equipment.		
Power		
Single phase, 100amp, Busbar Chamber situated upstage left fitted CEEFORM 30mA RCD (sound phase)		
	3 phase, 125amp CEEFORM	socket upstage left
	13amp sockets	fitted 30mA RCD, prompt corner (LX phase)
	13amp sockets	fitted 30mA RCD, upstage left wall (sound phase)
	13amp sockets	fitted 30mA RCD, upstage right wall (sound phase)
	16amp sockets	stage right (LX phase)
	13amp sockets	stage right (LX phase)
	13amp sockets	fitted RCD stage front at floor level
	16amp sockets	2 per stage LX bar
Rostra		
6	8' x 4'	Steeldeck (Four used for stage extension)
2	4' x 4'6"	Steeldeck
2	3'	Steeldeck Treads
4	1mx2m	Alideck
	4' Legs for the Steeldeck	
	2.5' Legs for the Steeldeck	
	2' Legs for the Steeldeck	
	1' Legs for the Steeldeck	
	30cm Legs for Alideck	
Masking		
	Black serge tabs (mid-stage)	
	Black twill borders 5' (1 Pleated)	
	6' x 18' twill soft legs	
Stage Management		
	Various Stage Weights	
	Various Stage Braces of assorted lengths	
4	Tank Traps	

Additional Equipment		
Stage Management		Q Light System with 4 outstations
Technical Extra's		Stage extension
		Haze machine
		Geyser
		Sparxtar
		Christie hanging projector
		Barco 4K projector
		Follow spot
		RGB LED Star cloth
		Mirror ball
		Pyrotechnic pods and firing unit
		Rifle Microphones
		Handheld Radio Microphones
		Headset/Lavalier belt pack Radio Microphones
<p>For a quotation on these additional hire items, please contact the Technical Manager.</p>		
Staffing		
<p>Wyllyotts Theatre provides two members of technical staff for get in and get out, a minimum of one technician will be present whilst you are occupying the Theatre. They are there to help you achieve the result you require within the latest legislations and house rules.</p> <p>Wyllyotts Theatre can provide additional crew for you, if you require, but this will be at an additional cost. We endeavor to keep these additional costs as low as possible.</p> <p>Thank you,</p> <p>Nigel Palmer Technical Manager</p>		